

Columbo with Desktop Enclosure

Compact, Durable FBI-Certified PIV* FAP 30 Single-Print Scanner

- Software-Based Autodetect
- Automatic Spoof Rejection
- Presentation Attack Detection w/SDK

Columbo sets the standard for fast, compact, FBI PIV single-print sensors. This FAP 30 scanner delivers exceptional quality and durability along with greater accuracy than FAP 10 or FAP 20 units, yet does so in a thin, lightweight form factor. Columbo sensors, whether standalone or embedded, require very little power to operate. Their low-maintenance design accurately scans old or damaged fingers and delivers reliable results even under extreme environmental conditions. Built for high-volume environments, Columbo also features a comprehensive software development kit (SDK) to streamline application integration.

The Columbo scanner and desktop enclosure are sold separately.

Features & Benefits

Faster

- Rapid, dry finger capture
- No need to clean latent prints in high-volume situations
- Easy integration via single SDK for all Integrated Biometrics FBI-certified products

Better

- Unaffected by extreme temperatures, direct sunlight, or bright artificial lights
- Compact, lightweight, and rugged
- Rejects common spoofing attacks
- Emits no bright lights during scans
- Meets or exceeds US military durability specifications

Smarter

- Competitive pricing
- Extremely low power consumption
- Eliminates consumables (silicone membranes or cleaning tape)
- Lower maintenance costs



- Columbo unit and DTE shown assembled here

**MITRE certification in process*



For more on Columbo, visit us at
integratedbiometrics.com/products/columbo

UNMISTAKABLE ID,
UNMISTAKABLY IB

Desktop Enclosure Assembly

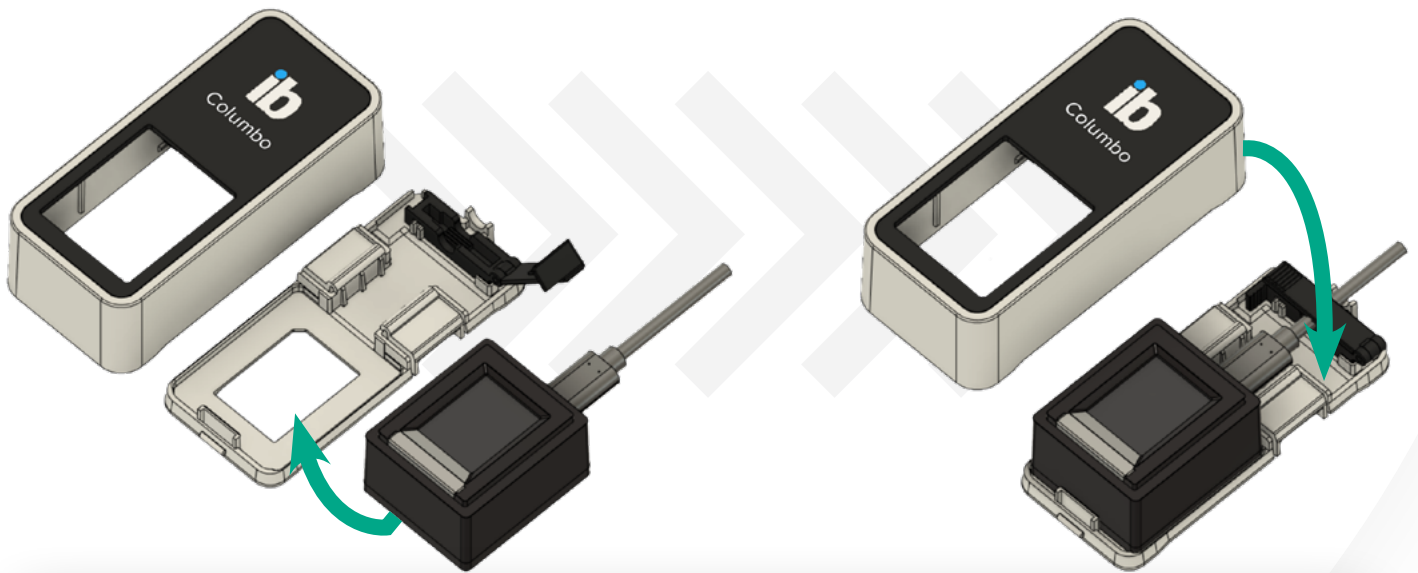

GENERATION	PART NUMBER	HOUSING/BEZEL STYLE
Columbo Desktop Enclosure (DTE)	CMDTPEC-000	Snap-on Enclosure

Light Emitting Sensor Technology & Columbo

Integrated Biometrics' scanners use our patented light-emitting sensor (LES) technology to deliver fixed and mobile FBI-certified fingerprint imaging in an exceptionally durable, lightweight scanner.

To learn more, go to integratedbiometrics.com/technology

Hardware-based Automatic Spoof Rejection

IB's LES film technology cannot be activated using common types of manufactured, fake fingerprints. Leveraging the electrical properties of human skin, LES film does not luminesce in the presence of fingerprints based on silicone, glues, rubbers, and other non-conductive materials.

Software-based Autodetect

IB's LES technology automatically detects the finger capture that generates the highest quality image without user intervention. Application developers enable this feature through IB's software development kit (SDK).

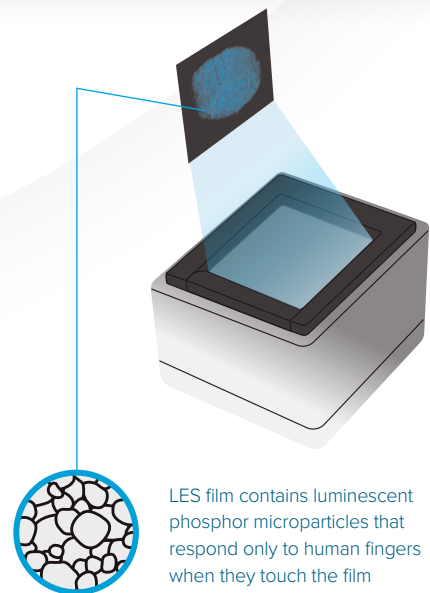

LES film contains luminescent phosphor microparticles that respond only to human fingers when they touch the film



ABOUT INTEGRATED BIOMETRICS

Integrated Biometrics (IB), a pioneer in biometrics technology, designs and manufactures advanced, high-resolution touchless identification SDK software and the world's most mobile, durable and reliable FBI-certified fingerprint sensors. Law enforcement, military, homeland security, national identity, election validation, financial and social services organizations around the world rely on Integrated Biometrics products for fast, accurate enrollment, identification and verification, even in remote locations under extreme conditions.